

Formerly known as Norris Creameries, Country Lake Foods,  
Land O' Lakes, Inc., and Dairy Fresh Foods



Since 1981 the principals of Evans Freimuth Architects, LLC have been the architects of numerous building additions and interior renovations for this facility.

These projects included the following:

- A 35,000 square foot Cooler and Truck Dock Addition which included 12 truck dock stalls.
- A 12,500 square foot Dry Storage and Milk Receiving Station with provisions for 3 drive-in tanker bays.
- A 6,000 square foot renovation of an existing Case Handling area. This renovation included over-building a new roof structure above the existing case room, then removing the old roof in order for the Owner to achieve a 2-story space for their required operations.
- A 9,000 square foot Milk Processing, Blow-Mold Production, and Engine Room addition.
- A 2,000 square foot Office addition with a 3,500 square foot adjacent Office renovation project.
- A 10,000 square foot 2 story addition for offices, Reception, Conference Room, Boiler Room, and Maintenance.

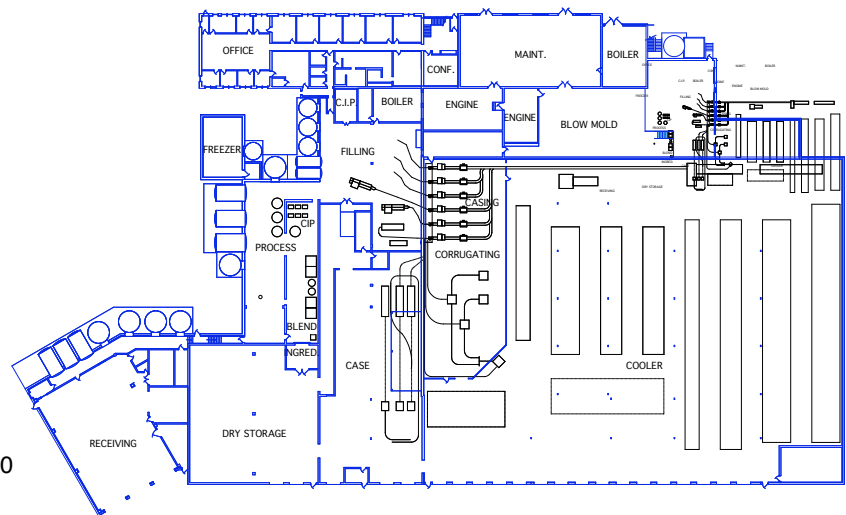

1  
A1 REFERENCE PLAN

Both James Evans and Dick Freimuth were the Project Architects for these Projects while employed at another Architectural firm.